



CONFORMITY DECLARATION

We declare that we manufacture our valve according to

PRODUCT Article No. **420**
Brass ball valve for gas
WORKING TEMPERATURE: from -10°C up to $+60^{\circ}\text{C}$
WORKING PRESSURE: max working limit MOP 5
THREAD: female on both side according to UNI EN ISO 7 standard
WAY: full way

ANTI EJECTION STEM
PRODUCTION DATE on the valve
Reversible handle and lever
FACTORY WARRANTY 2 YEARS (except for defects in installation and / or use)

BRASS: according to UNI EN 12165 (alloy CW 617N) standard
STEM: in brass according to UNI EN 12164 (alloy CW614N)
SEAL ON THE STEM with 2 O Ring according to EN 549
BALL: : in brass, diamond cut and hard chromium plated
GASKET ON THE BALL two gasket in pure PTFE
LEVER: in drawn steel lever
SCREW: stainless steel AISI 430

USE gas according to EN 331

ADDITIONAL INFORMATION:

- CERTIFICATION DVGW NR. NG-4312BO0117 ACCORDING TO EN 331 STANDARD

We confirm you that our valve is entirely manufactured in Italy, in our factory in Farigliano (CN) - in accordance with ISO 9001: 2008 standards – from attention to the selection of the materials used in the production process, in both the processing and product, in respect of environmental and consumer well-being in order to obtain MADE IN ITALY valves with quality and high reliability.





AVAILABLE VERSION

Lever in steel

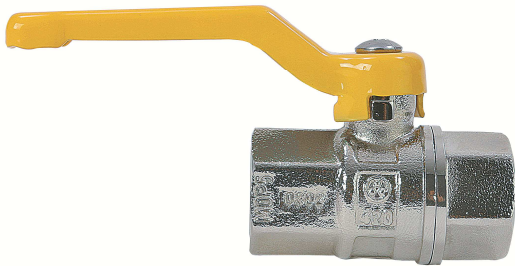
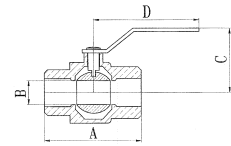

Code	A	B	C	D
420C3/8C1G	48	11	43	83
420D1/2C1G	58	15	43	83
420E3/4C1G	70	20	47	83
420F001C1G	83	25	64	90
420G11/4C1G	97	32	69	90
420H11/2C1G	106	40	79	110
420I002C1G	131	50	110	130

Handle in aluminium



Code	A	B	C	D
420C3/8C2G	48	11	37	31
420D1/2C2G	58	15	36	31
420E3/4C2G	70	20	40	31
420F001C2G	83	25	51	43
420G11/4C2G	97	32	67	50

Available also with:

- Lever or handle in blue colour
- Handle in brass